

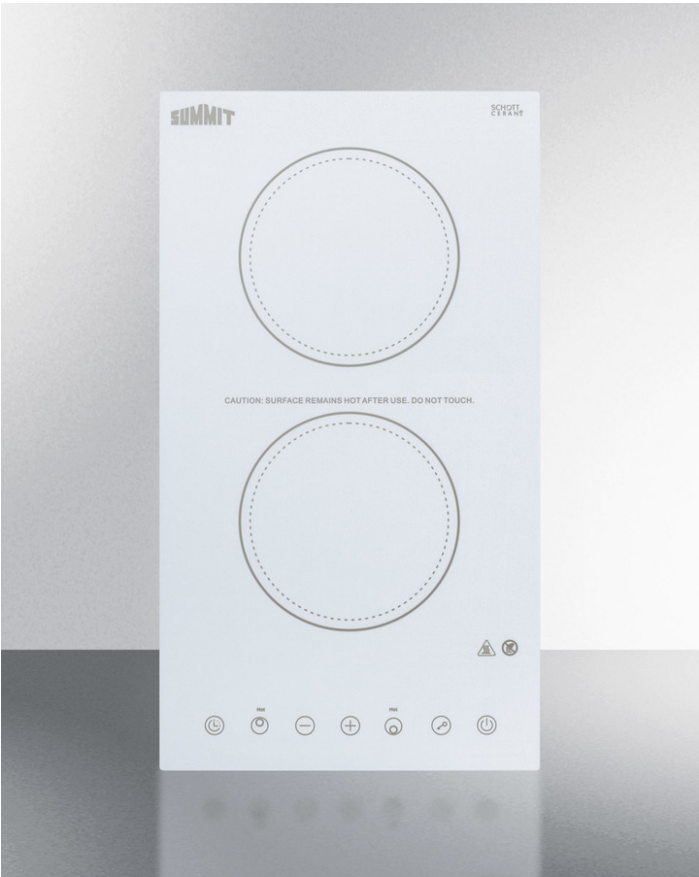

CR2B15T2W



2" x 11.38" x 20.5" (H x W x D)

115V 2-burner cooktop in white ceramic Schott glass with digital touch controls, 2400W

Highlights:

Two-burner 2400W electric cooktop with 115V operation

Intuitive touch controls for smarter cooking

Smooth ceramic glass surface made with white Schott glass offers a modern look that's easy to clean

Product Features:

Schott glass surface	Made in Germany, the white Schott glass offers easier cleanup and lasting durability
Two heating elements	Includes 2 1200W 5 1/5" burners to cover most cooking needs
Digital touch controls	Easy operation with a digital control panel and digital display
9 power levels	Select and adjust your heating levels at the touch of a button
Residual heat indicator lights	Each burner includes a residual heat indicator to warn users if the surface is still too hot to touch
Designed for built-in installation	Fits counter cutout sizes that are 10.75" wide by 19.9" deep
ADA compliant design	Upfront controls meet ADA guidelines for easier accessibility
Timer	Allows you to program either burner to heat at a specified level for up to 99 minutes
Child lock	Safety feature lets you lock the cooktop to prevent unsupervised heating



CR2B15T2W Specifications:

Overview	
Height of Cabinet	2.0" (5 cm)
Width	11.38" (29 cm)
Depth	20.5" (52 cm)
Cabinet	White
US Electrical Safety	ETL
Canadian Electrical Safety	ETL-C
Amps	20.0
Voltage/Frequency	115 V AC/60 Hz
Weight	10.0 lbs. (5 kg)
Shipping Weight	12.0 lbs. (5 kg)
Estimated Time to Ship	Next day shipping
Parts & Labor Warranty	1 Year
Electric Cooktop	
Heating Type	Radiant
Surface	Glass
Element Type	Glasstop
Number of Elements	2
controls	Digital
Cooking Timer	Yes
Countertop Cutout Height	5.9" (15 cm)
Countertop Cutout Width	10.75" (27 cm)
Countertop Cutout Depth	19.9" (51 cm)
Power Source	115V
Element #1 Size	5.5" (14 cm)
Element #1 Wattage	1200.0
Element #2 Size	5.5" (14 cm)
Element #2 Wattage	1200.0

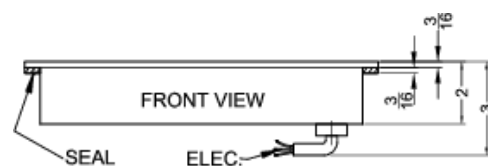
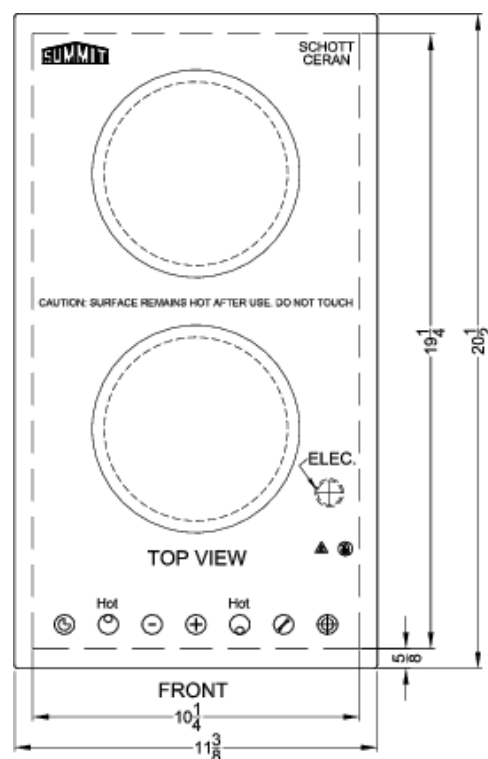

MODEL: CR2B15T1B
CR2B15T2W
120V-60HZ 2400W MAX.