

Priming Your Hi-Pressure Unit

1. Follow directions in the “Getting Started” section of your instruction manual.
2. Once the fan and base are in place and the filter is underwater at the bottom of the cooler plug in the fan and unscrew any nozzle.
3. Turn the unit to the “on” position.
4. When water consistently flows through the nozzle opening, turn the ring valve to the “closed” position (the ring valve is shipped in the “open” position) and screw the nozzle back in by hand tightening in the clockwise direction.
5. Once the nozzle is in, turn the ring valve back to “open.”

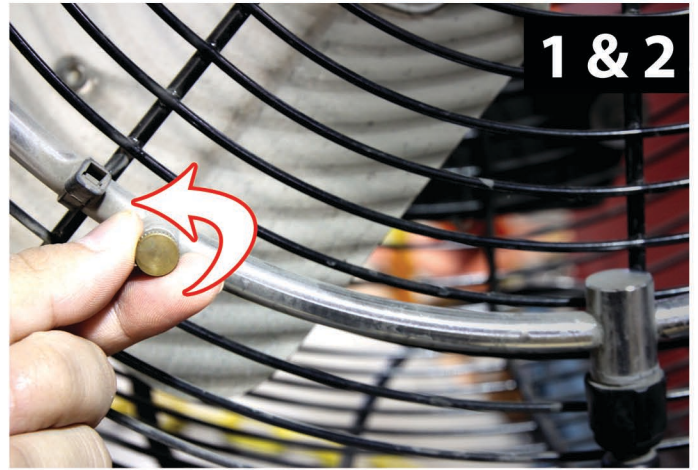

Valve in the “OFF” Position
NO WATER FLOW
CLOSED

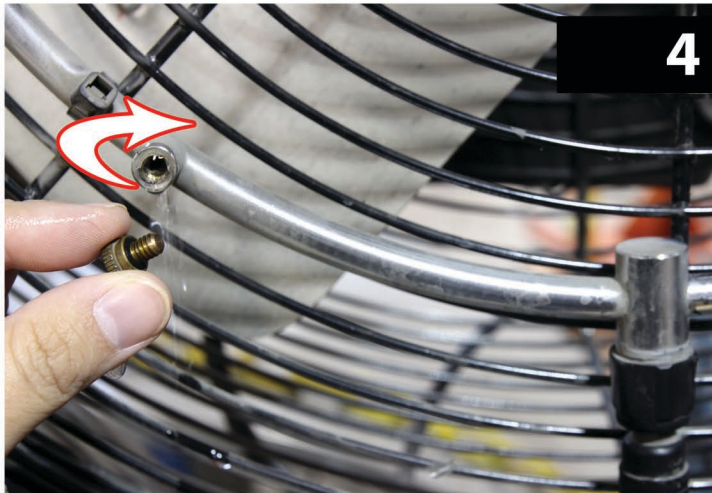

5



Valve in the “ON” Position
WATER FLOW
OPEN



6. Turn the switch to get the desired speed. *This step is optional, as some customers prefer to run just the pump with no fan.*