

ASSEMBLY INSTRUCTIONS

STAND AND BASE ASSEMBLY

1. Remove 5 screws from base frame (1).
2. Place stand pipe with spring (3) on base frame (1) and align holes in bottom of stand pipe (3) with holes in base frame (1).
3. Insert screws removed in Step 1 and tighten securely.
4. Slide base collar (2) down over the bottom of stand pipe (3).

POLE ASSEMBLY

1. Remove 2 screws (4) from adjustment collar of extension pipe (7) and loosen height adjustment knob (6) on adjustment collar.
2. Make sure spring (5) is in stand pipe (3).
3. Insert extension pipe (7) into stand pipe (3).
4. Align 2 holes on stand pipe (3) with holes in adjustment collar, secure adjustment collar with 2 screws (4) removed in Step 2.
5. Adjust extension pipe (7) to desired height.
6. Tighten height adjustment knob (6) to set height.

STAND AND YOKE ASSEMBLY

1. Remove bolt and nut (8) from bottom of yoke frame.
2. Align upper hole on extension pipe (7) with lower hole in the yoke assembly.
3. Insert bolt and replace nut (8) removed in Step 1.

ADJUSTING THE AIRFLOW

Unplug the unit. Loosen the pivot knobs on both sides of the fan head. Tilt fan head to desired angle, and tighten pivot knobs. Reconnect unit to power supply.

USER SERVICING INSTRUCTIONS

CAUTION: Disconnect the power to the fan before cleaning.

- Use a soft, damp cloth to clean the fan. Remove any residual moisture with a dry cloth.
- Do not use any chemical solution that is harmful to paint or plastic.
- Do not bend the blades when cleaning.
- If the power cord is damaged, it must be replaced by the manufacturer, its agent or authorized service personnel.

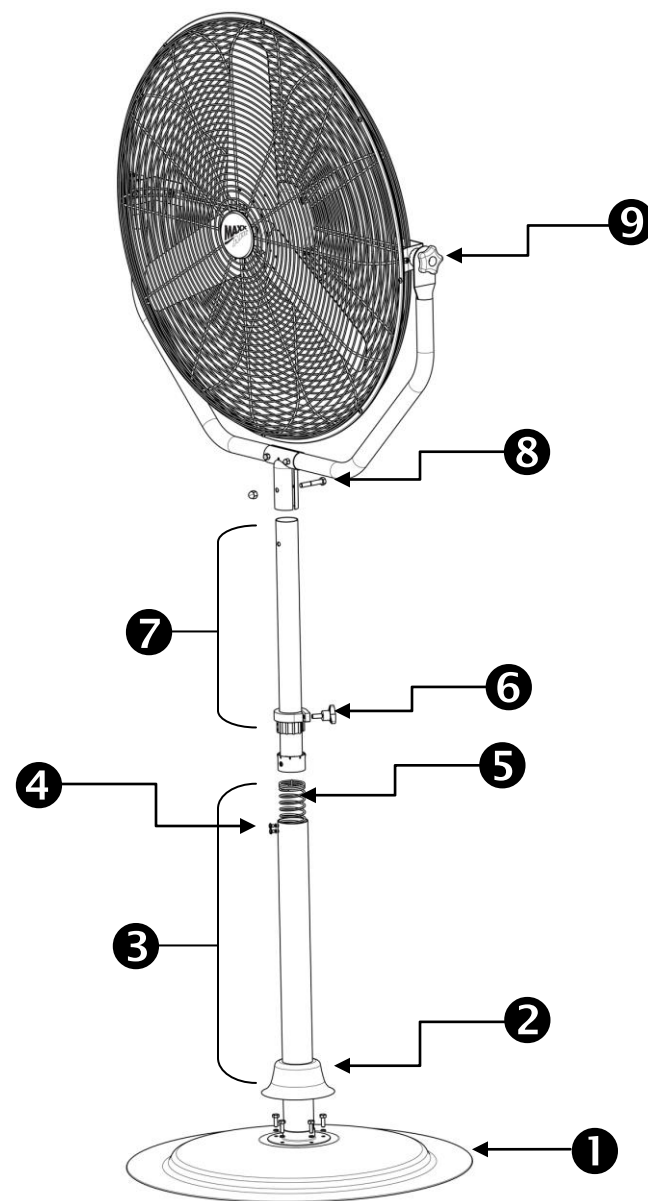

PLEASE NOTE: The motor bearings for this MaxxAir fan are permanently sealed and do not require additional lubrication.

If you have any questions regarding the operation of your MaxxAir fan, contact Ventamatic, Ltd. Online USA 940-325-7887.



30-INCH YOKE PEDESTAL FAN ASSEMBLY AND OPERATING INSTRUCTIONS

CONGRATULATIONS ON YOUR MAXX AIR FAN PURCHASE. With proper care and maintenance your fan will give you many years of use.

CAUTION: READ AND FOLLOW ALL INSTRUCTIONS BEFORE OPERATING FAN.

IMPORTANT SAFETY INSTRUCTIONS - READ AND SAVE THESE INSTRUCTIONS

WARNING – TO REDUCE THE RISK OF FIRE, ELECTRIC SHOCK OR INJURY TO PERSONS, OBSERVE THE FOLLOWING :

- | | |
|---|--|
| <ul style="list-style-type: none">• Disconnect fan when moving from one location to another.• Disconnect fan when removing guards for cleaning.• Make sure fan is on a stable, flat surface when in operation.• Rain and moisture may create an electrical hazard.• This appliance has a 3-prong plug. To reduce the risk of electrical shock, this plug is intended to fit in an outlet one way. If this plug does not fit in the outlet, contact a qualified electrician.• The fan may be adjusted to a maximum height of 66.5 inches (1.69 meters). To avoid possible tipover, do not adjust the fan beyond the maximum height. | <ul style="list-style-type: none">• WARNING: Do not use this fan with any solid-state speed control device.
AVERTISSEMENT: NE CONVIENT PAS À DES RÉGULATEURS DE VITESSE À SEMI-CONDUCTEURS.• CAUTION: For general ventilating use only. Do not use to exhaust hazardous or explosive materials or vapors.• CAUTION: Disconnect the power to the fan before cleaning.• DO NOT insert fingers or any objects through grille guard when fan is in operation.• DO NOT operate fan if any part is damaged or missing. |
|---|--|

LIMITED WARRANTY

Ventamatic, Ltd. extends this warranty to the original retail purchaser of this fan. The fan is warranted against defects in materials and workmanship for a period of two (2) years from the date of original retail purchase. No other parts or components are warranted. There is no warranty for defects caused by abuse. Repairs or replacement parts supplied under this warranty are warranted only for the period of this warranty; that is, two (2) years from the date of the original retail purchase of the unit.

In the event of a defect or malfunction, we will replace or repair the defective part or component only and return the new or repaired part to you freight prepaid. You must bear all other expenses incurred in obtaining repairs, including labor required for field repair or replacement, and the cost of shipping the defective part to us. You must also bear the cost of repair to or replacement of any part or component and the shipping charges incurred for the repair or replacement and return to you of any part or component not covered by this warranty, including parts or components damaged by you.

The company reserves the right to demand and receive written evidence of the date of purchase before undertaking to perform its obligations under this warranty. You should, therefore, retain your sales slip and attach a copy of it to the warranty claim. In order to obtain the repair or replacement of this unit, you must select one of the following methods:

A. Return to factory.

Return postage prepaid only the part or component which you believe to be defective to the following address:

Ventamatic, Ltd

100 Washington Street

Mineral Wells, TX 76067

Complete and enclose a written claim and attach a copy of your sales slip or other proof of purchase.

B. Return to retail dealer.

There is no informal dispute settling mechanism available in the event of a controversy involving this warranty.

Any and all implied warranties which may exist terminate upon the expiration of this warranty two (2) years from the date of the original retail purchase. Some states do not allow limitations on how long an implied warranty lasts, so this limitation may not apply to you. Ventamatic, Ltd. is not liable to you for incidental or consequential damages arising out of a defect or malfunction of a unit or its installation or out of any alleged breach of this warranty. Some states do not allow the exclusion or limitation of incidental or consequential damages, so this limitation may not apply to you.

This warranty gives you specific legal rights and you may also have other rights which may vary from state to state.