

# ACR1322GNSF456LHD



64.88" x 23.38" x 28" (H x W x D)

Upright healthcare all-refrigerator with self-closing glass door, front lock, digital controls, and external temperature readout

### Highlights:

Specially designed to meet current CDC/VFC vaccine refrigeration guidelines for convenient storage in pharmacies, medical offices, and other healthcare facilities

Certified to NSF/ANSI 456 Vaccine Storage Standard

Designed and constructed for reliable cold storage in healthcare facilities

### Product Features:

|  |  |
|--|--|
| EQTemp Medical Refrigerator                        | All-refrigerator designed to operate between 2 and 8°C for a variety of storage application in medical offices and other healthcare facilities   |
| Certified to NSF/ANSI 456 Vaccine Storage Standard | Tested to comply with the latest standards   |
| Certificate of calibration included                | The temperature monitoring device (TMD) is calibrated to NIST standards in our ISO/IEC 17025:2017 certified calibration laboratory and ships with a 2-year certificate of calibration for your records                                     |
| Temperature Range: 2° to 8°C                       | Preset to 5°C as recommended for many storage applications   |
| Large capacity                                     | Full 12.71 cu.ft. capacity inside conveniently slim footprint  |
| External temperature readout                       | Audible alarm sounds if the interior temperature rises or falls out of set range   |
| High/low temperature alarm                         | Thermometer probe is encased in a glass bead-filled bottle and stored in a fixed box on the center shelf. This is the ideal way to produce temperature readings closest to stored contents, as recommended by the CDC and VFC's guidelines |
| Buffered temperature probe                         | Thermometer probe is encased in a glass bead-filled bottle and stored in a fixed box on the center shelf. This is the ideal way to produce temperature readings closest to stored contents, as recommended by the CDC and VFC's guidelines |



## ACR1322GNSF456LHD Specifications:

### Overview

|                            |                      |
|----------------------------|----------------------|
| Nominal Width              | 24.0" (61 cm)        |
| Nominal Depth              | 28.0" (71 cm)        |
| Nominal Height             | 65.0" (165 cm)       |
| Height of Cabinet          | 64.88" (165 cm)      |
| Width                      | 23.38" (59 cm)       |
| Width with Door Open       | 23.63" (60 cm)       |
| Depth                      | 28.0" (71 cm)        |
| Depth with door at 90°     | 50.0" (127 cm)       |
| Capacity                   | 12.71 cu.ft. (360 L) |
| Defrost Type               | Automatic            |
| Door                       | Glass                |
| Cabinet                    | White                |
| US Electrical Safety       | ETL                  |
| Canadian Electrical Safety | ETL-C                |
| Sanitation                 | ETL-S to NSF 456     |
| Amps                       | 2.0                  |
| Voltage/Frequency          | 115 V AC/60 Hz       |
| Weight                     | 169.0 lbs. (77 kg)   |
| Parts & Labor Warranty     | 1 Year               |
| Compressor Warranty        | 5 Years              |
| UPC                        | 761101107783         |

### Refrigerator Features

|                    |                    |
|--------------------|--------------------|
| Door Swing         | LHD                |
| Reversible         | Factory Reversible |
| Shelf Type         | Wire               |
| Shelf Qty          | 5                  |
| Adjustable Shelves | Yes                |
| Thermostat Type    | Digital            |
| Fan Type           | Interior           |
| Refrigerant Type   | R600a              |
| Refrigerant Amount | 2.0oz.             |
| High Side PSI      | 1.45               |
| Low Side PSI       | 0.85               |
| Level Legs Qty     | 2                  |
| Interior Light     | Yes                |
| Temperature Range  | 2° to 8°C          |
| Sound Level        | 38.9 dB            |

### Dimensions

|                        |                |
|------------------------|----------------|
| Interior Height        | 56.5" (144 cm) |
| Interior Width         | 20.0" (51 cm)  |
| Interior Depth         | 21.5" (55 cm)  |
| Compressor Step Height | 9.0" (23 cm)   |
| Compressor Step Width  | 20.0" (51 cm)  |
| Compressor Step Depth  | 8.0" (20 cm)   |

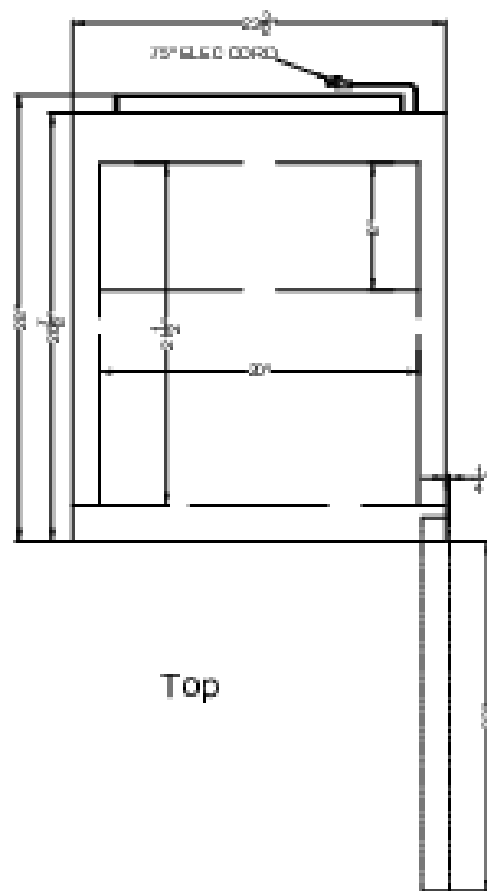

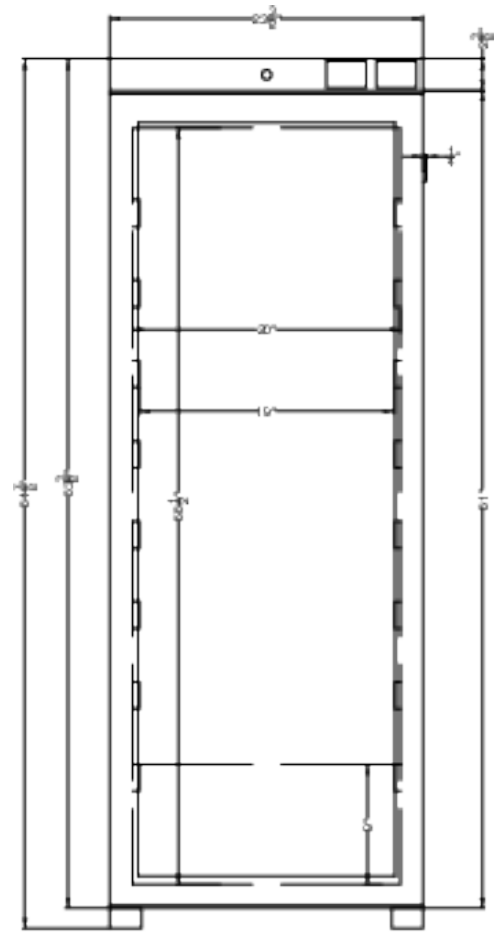

Front