

ACR1602GLHD



76.75" x 23.38" x 28" (H x W x D)

Upright healthcare all-refrigerator with self-closing glass door, front lock, digital controls, and external temperature readout

Highlights:

External temperature readout of the current and high/low temperatures

User-friendly front control panel keeps the thermostat and alarm in reach without having to open the door

Self-closing door protects interior products from ambient temperatures

Product Features:

EQTemp Medical Refrigerator	All-refrigerator designed to operate between 2 and 8°C for a variety of storage application in medical offices and other healthcare facilities
Buffered temperature probe	Thermometer probe is encased in a glass bead-filled bottle and stored in a fixed box on the center shelf. This is the ideal way to produce temperature readings closest to stored contents, as recommended by the CDC and VFC's guidelines
High/low temperature alarm	Audible alarm sounds if the interior temperature rises or falls out of set range
External temperature readout	Includes continuous display of the current interior and high/low temperature, and can be switched from Celsius to Fahrenheit at the touch of a button
Large capacity	Complete 15.53 cu.ft. capacity inside conveniently slim footprint
Temperature Range: 2° to 8°C	Preset to 5°C as recommended for many storage applications
Fully finished white cabinet	Allows the unit to be used freestanding
Magnetic door gasket	Quality door gaskets ensure a tight seal for energy savings and improved performance
Digital thermostat	Digital microprocessor for easy and precise temperature management, with all controls externally located for added convenience

ACR1602GLHD Specifications:

Overview

Nominal Width	24.0" (61 cm)
Nominal Depth	28.0" (71 cm)
Nominal Height	77.0" (196 cm)
Height of Cabinet	76.75" (195 cm)
Width	23.38" (59 cm)
Width with Door Open	23.63" (60 cm)
Depth	28.0" (71 cm)
Depth with door at 90°	50.0" (127 cm)
Capacity	15.53 cu.ft. (440 L)
Defrost Type	Automatic
Door	Glass
Cabinet	White
US Electrical Safety	ETL
Canadian Electrical Safety	ETL-C
Amps	2.0
Voltage/Frequency	115 V AC/60 Hz
Weight	176.4 lbs. (80 kg)
Parts & Labor Warranty	1 Year
Compressor Warranty	5 Years
UPC	761101107653

Refrigerator Features

Door Swing	LHD
Reversible	Factory Reversible
Shelf Type	Wire
Shelf Qty	6
Adjustable Shelves	Yes
Thermostat Type	Digital
Fan Type	Interior
Refrigerant Type	R600a
Refrigerant Amount	2.4oz.
High Side PSI	1.45
Low Side PSI	0.8
Level Legs Qty	2
Interior Light	Yes
Temperature Range	2° to 8°C
Sound Level	38.8 dB

Dimensions

Interior Height	68.25" (173 cm)
Interior Width	20.0" (51 cm)
Interior Depth	21.5" (55 cm)
Compressor Step Height	9.0" (23 cm)
Compressor Step Width	20.0" (51 cm)
Compressor Step Depth	8.0" (20 cm)

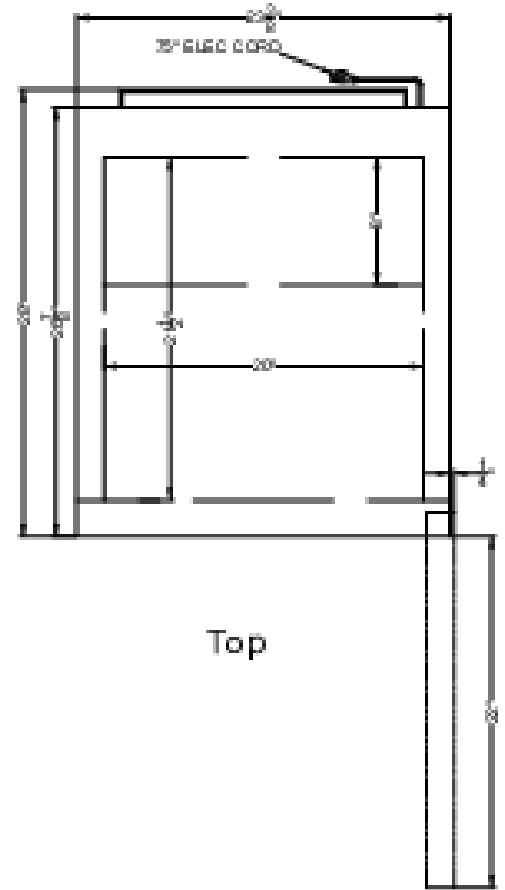

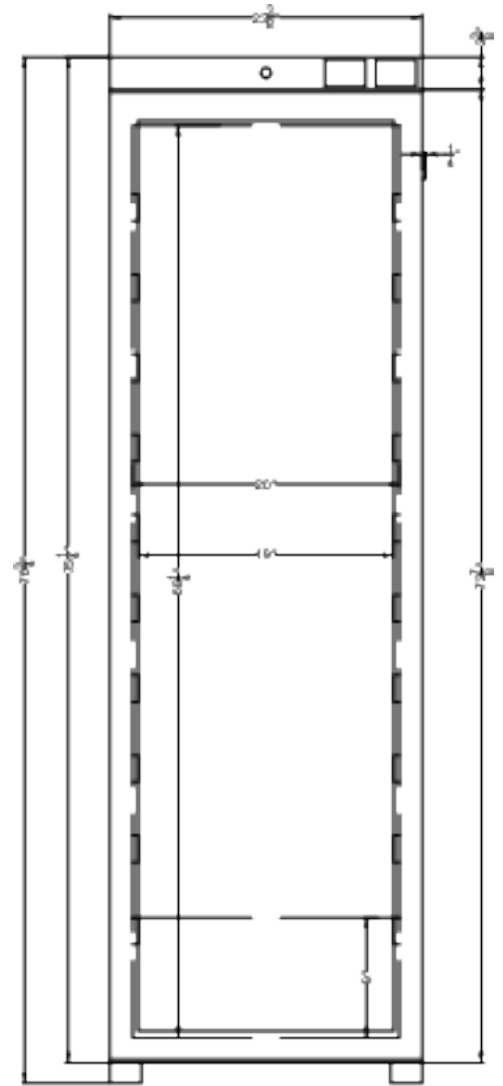

Front